



Cambridge City Council Licensing Sub Committee

Date: Monday, 3 June 2024

Time: 10.00 am

Venue: Council Chamber, The Guildhall, Market Square, Cambridge, CB2 3QJ [access the building via Peashill entrance]

Contact: democratic.services@cambridge.gov.uk, tel:01223 457000

Agenda

- 1 Appointment of a Chair
- 2 Declarations of Interest
- 3 Meeting Procedure
- 4 Tesco, East Road, Premises Licence (Pages 7 - 62)

Information for the public

The public may record (e.g. film, audio, tweet, blog) meetings which are open to the public.

For full information about committee meetings, committee reports, councillors and the democratic process:

- Website: <http://democracy.cambridge.gov.uk>
- Email: democratic.services@cambridge.gov.uk
- Phone: 01223 457000

This Meeting will be live streamed to the Council's YouTube page. You can watch proceedings on the livestream or attend the meeting in person.

Those wishing to address the meeting will be able to do so virtually via Microsoft Teams, or by attending to speak in person and have completed an LRA1 form to express your intention to speak.

Licensing Act 2003 - Licensing Sub-Committee: Hearings Procedure

Preliminary Matters

1. **The Chair** will commence the hearing by introducing him/herself, the other two members of the Sub-Committee and the officers present.
2. **The Chair** will ask the applicant(s)/the responsible authorities/the interested parties present, and their representatives (if applicable), to introduce themselves and identify their interest in the proceedings.

Failure of a party to attend the hearing

3. If a party has informed the licensing authority that he/she does not intend to attend or be represented at a hearing, the hearing may proceed in his/her absence.
4. If a party who has not so indicated fails to attend or be represented at a hearing, the Sub-Committee may –
 - (a) where it considers it to be necessary in the public interest, adjourn the hearing to a specified date, or
 - (b) hold the hearing in the party's absence.
5. Where the Sub-Committee holds the hearing in the absence of a party, the Sub-Committee will consider at the hearing the application, representations or notice made by that party.
6. **The Chair** will explain the procedure to be followed at the hearing and will confirm whether the Sub-Committee must reach its decision at the end of the hearing or within 5 working days of the hearing, depending on the application being heard.
7. **The Clerk to the Sub-Committee** will indicate whether any party has requested permission for any other person(s) (other than his/her representative) to appear at the hearing to assist the Sub-Committee in relation to the application, representations or notice of the party making the request. The Sub-Committee will decide whether to grant permission to allow any other person(s) to appear at the hearing on behalf of the party; such permission will not be unreasonably withheld.
8. **The Clerk to the Sub-Committee** will ask whether any party is seeking to introduce any document(s) or other information not previously disclosed to all the other parties to the hearing and the licensing authority. If all the other parties consent, the previously undisclosed document(s) or other information can be produced by a party in support of their application, representations or notice (as applicable).
9. The hearing will take the form of a discussion led by the Chair of the Sub-Committee. Cross-examination will not be permitted unless the Sub-Committee considers that cross-examination is required to

consider the representations, application or notice as the case may require.

10. The Sub-Committee will consider any requests to permit cross-examination on a case-by-case basis. When permission is given to one party, it will also normally be extended to all other parties.
11. The Sub-Committee will decide the equal maximum period of time that each party will have to present their case.

The Hearing

12. *The Licensing Officer will present the report to the Sub-Committee.*
13. Members may ask any relevant questions of the Licensing Officer.
14. *The applicant, or the party who has initiated the hearing, will present their case first.*
15. The party shall be entitled to:
 - (a) give further information in support of their application, representations or notice (as applicable) in response to a specific request by the licensing authority prior to the hearing;
 - (b) question any other party (if permission has been given by the Sub-Committee);
 - (c) address the Sub-Committee.
16. If the Police are a party to the hearing, they will present their case. The Police have the rights listed in paragraph 15 (a) – (c) above.
17. If any other “responsible authority” are a party to the hearing, they will present their case in turn after the Police and have the rights listed in paragraph 15 (a) – (c) above.
18. Any other interested parties will then present their case in turn and have the rights listed in paragraph 15 (a) – (c) above.
19. Members of the Sub-Committee may ask questions of the/each party or any other person permitted to appear at the hearing in support of the party.
20. **The Chair** will invite the applicant, or the party who has initiated the hearing, and any parties making representations, to briefly summarise their points if they wish.
21. **The Chair** will ask the applicant, or the party who has initiated the hearing, and all parties making representations, that they are satisfied that they have said all they wish to.

The Decision

22. In considering any representations or notice made by a party, the Sub-Committee may take into account documentary or other information produced by a party in support of their application, representations or notice (as applicable) either before the hearing or, with the consent of all the other parties, at the hearing.

23. In reaching its decision, the Sub-Committee will disregard any information given by a party, or any person who has been permitted to appear at the hearing, which is not relevant to –
- (a) the application, representations or notice (as applicable) or in the case of another person, the application, representations or notice of the party requesting their appearance, and
 - (b) the promotion of the licensing objectives or, in relation to a hearing to consider a notice given by the Police, the crime prevention objective.
24. The Sub-Committee may consider its decision in private and may move into private session where it considers that the public interest in so doing outweighs the public interest in that part of the hearing taking place in public. If the Sub-Committee do move into private session then all the parties and their representatives, any other person permitted to appear at the hearing, officers, the public and the press will be asked to leave the room whilst the decision is made.

The Chair will tell those present at the meeting the decision taken by the Sub-Committee and the reasons for the decision.

This page is intentionally left blank



CONSIDERATION OF AN APPLICATION FOR A PREMISES LICENCE TO BE GRANTED

Tesco, 172 East Road, Cambridge, CB1 1BG

To: Licensing Sub-Committee:

Report by: Luke Catchpole

Environmental Health and Licensing Support Team Leader

Tel: 01223 457818

E-mail: luke.catchpole@cambridge.gov.uk

Wards affected: Market

INTRODUCTION

- 1.1 An application under section 17 of the Licensing Act 2003 to apply for a Premises Licence for the sale by retail of alcohol with respect to Tesco, 172 East Road, Cambridge, CB1 1BG has been received from Tesco Stores Limited. The application was served on Cambridge City Council (the Licensing Authority) on 12th April 2024. A copy of the application was also served on each responsible authority. The application and plan is attached to the report at Appendix 1.
- 1.2 The applicant is seeking to provide the sale of alcohol only (for consumption off the premises only) from Monday to Sunday between the hours of 11:00 and 20:00.

- 1.3 In accordance with the regulations of the Act, the application was advertised on the premises and in Cambridge News on 19th April 2024 to invite representations from responsible authorities and other persons. The last date for submitting representations was 10th May 2024.
- 1.4 Representations were received from 19 'Other Persons'. The representations are attached to the report at Appendix 2.
- 1.5 No representations were received from any of the Responsible Authorities but Cambridgeshire Constabulary did request to amend one of the conditions proposed by the applicant in the operating schedule, which the applicant agreed to. A copy of the email is attached to the report at Appendix 3.
- 1.6 A list of all the conditions proposed by the applicant and the one amended in conjunction with Cambridgeshire Constabulary have been put into a document attached to the report as Appendix 4. If the application is granted, these conditions will be placed on Annex 2 of the Premises Licence unless amended or added to by members of the Licensing Sub-Committee.
- 1.7 The application needs to be determined.

2. RECOMMENDATION

- 2.1 That Members determine the application on its individual merits having reference to the statutory licensing objectives and Cambridge City Council's Statement of Licensing Policy and the Cumulative Impact Assessment.

3. BACKGROUND

- 3.1 The proposed premises is located within a Cumulative Impact Area (CIA) and is therefore subject to the Cumulative Impact Assessment.
- 3.2 The onus is on the applicant to demonstrate why the granting of the licence would not add to the cumulative impact already being experienced within the area.

- 3.3 Three previous applications have been made for a Premises Licence to be issued in respect of these premises. These were received on 17th November 2009, 10th August 2010 and 10th December 2018. respectively. All three applications were refused at hearings of the Licensing Sub-Committee after relevant representations had been received.
- 3.4 In carrying out its licensing functions, the Licensing Authority must have regard to its Statement of Licensing Policy, the Cumulative Impact Assessment and additionally the statutory guidance issued under Section 182 of the Licensing Act 2003. The relevant sections from the Council's Statement of Licensing Policy are:
- Objectives, section 2
 - Fundamental principles, section 4
 - Cumulative Impact, section 5
 - Licensing Hours, section 6
 - Licence Conditions, section 8

4. CONSULTATIONS

- 4.1 The Licensing Act 2003 requires applications made under section 17 of the Act to be served on the Responsible Authorities and also advertised on the premises and in a local newspaper circulating within the vicinity of the premises. During the consultation period, Responsible Authorities and Other Persons (any individual, body or business entitled to make representations to licensing authorities) may make a representation in respect of the application.
- 4.2 Statutory consultation has therefore taken place with Responsible Authorities and interested parties in accordance with the procedures set out in the Licensing Act 2003 and associated regulations made under the Act.

5. OPTIONS

- 5.1 Whilst having reference to the information provided by the applicant, the information raised in the representations and also Cambridge City Council's Statement of Licensing Policy and Cumulative Impact Assessment, the Sub-Committee's decision must be made with a view to promoting one or more of the four licensing objectives, namely:

- (a) the prevention of crime and disorder;
- (b) public safety;
- (c) the prevention of public nuisance; and
- (d) the protection of children from harm.

5.2 Members should take such steps that they consider are necessary for the promotion of the licensing objectives. The Sub-Committee may resolve:

- (a) to grant the licence subject to the mandatory conditions and those conditions offered by the applicant which may be modified to such extent as the authority considers necessary for the promotion of the licensing objectives;
- (b) to exclude from the scope of the licence any of the licensable activities to which the application relates;
- (c) to refuse to specify a person in the licence as the premises supervisor;
- (d) to reject the application.

5.3 Members must give reasons for their decision.

6. CONCLUSIONS

6.1 The Licensing Authority has a duty under the Licensing Act 2003 to promote the Licensing Objectives. Each objective has equal importance. In carrying out its licensing functions, the Licensing Authority must also have regard to its Statement of Licensing Policy, the Cumulative Impact Assessment and the Statutory Guidance under the Licensing Act 2003, and it is bound by the Human Rights Act 1998. The Council must also fulfill its obligations under Section 17 of the Crime and Disorder Act 1998 to do all that it reasonably can to prevent crime and disorder in Cambridge.

7. IMPLICATIONS

(a) Financial Implications

Cambridge City Council (the Licensing Authority) has a statutory duty to determine applications made under the Licensing Act 2003. The application fees associated with such applications are set by Central

Government and are intended to cover the cost of administering the licensing regime.

There are no specific financial implications associated with this report.

(b) **Staffing Implications**

There are no staffing implications associated with this report.

(c) **Equal Opportunities Implications**

No Equality Impact Assessment has been conducted as the only consideration in reaching a decision is whether the granting of the application will undermine the statutory licensing objectives.

(d) **Environmental Implications**

Any environmental implications that need to be considered must specifically relate to the promotion of the statutory licensing objectives and will be contained in the representations made by the responsible authorities or interested parties.

(e) **Community Safety**

Cambridge Constabulary, Cambridgeshire Fire & Rescue Service, Cambridge City Council's Environmental Health Team, Cambridge City Council's Planning Service, Cambridgeshire County Council's Child Protection & Review Unit, Cambridgeshire County Council's Trading Standards Department and the Public Health Director were consulted as part of the application process and could have made representation if it was considered that the granting of the application would undermine one or more of the statutory licensing objectives.

Those making representations would have raised any relevant community safety implications.

8. BACKGROUND PAPERS: The following are the background papers that were used in the preparation of this report:

- [Licensing Act 2003](#)
- [The Licensing Act 2003 \(Premises licences and club premises certificates\) Regulations 2005](#)

- [Guidance issued under section 182 of the Licensing Act 2003](#)
- [Cambridge City Council's Statement of Licensing Policy](#)
- [Cambridge City Council's Cumulative Impact Assessment](#)

Appendix 1 – Application Form and Plans

Appendix 2 – Representations

Appendix 3 – Amended condition agreed with Police

Appendix 4 – Proposed conditions

To inspect these documents either view the above hyperlinks or contact the Commercial & Licensing Team at taxi@cambridge.gov.uk.

The author and contact officer for queries on the report is luke.catchpole@cambridge.gov.uk

Date originated: 14th May 2024

Last updated: 14th May 2024

Application for a premises licence to be granted under the Licensing Act 2003

PLEASE READ THE FOLLOWING INSTRUCTIONS FIRST

Before completing this form, please read the guidance notes at the end of the form. If you are completing this form by hand, please write legibly in block capitals. In all cases ensure that your answers are inside the boxes and written in black ink. Use additional sheets if necessary.

You may wish to keep a copy of the completed form for your records.

I/We Tesco Stores Limited

(Insert name(s) of applicant)

apply for a premises licence under section 17 of the Licensing Act 2003 for the premises described in Part 1 below (the premises) and I/we are making this application to you as the relevant licensing authority in accordance with section 12 of the Licensing Act 2003

Part 1 – Premises details

Postal address of premises or, if none, ordnance survey map reference or description			
Tesco Express, 172 East Road, Cambridge, CB1 1BG			
Post town	Cambridge	Postcode	CB1 1BG
Telephone number at premises (if any)			
Non-domestic rateable value of premises		TBC - Not yet valued - Fee of £190 will be made to cover the cost of the application	

Part 2 - Applicant details

Please state whether you are applying for a premises licence as

Please tick as appropriate

- | | | |
|--|-------------------------------------|-----------------------------|
| a) an individual or individuals * | <input type="checkbox"/> | please complete section (A) |
| b) a person other than an individual * | | |
| i as a limited company/limited liability partnership | <input checked="" type="checkbox"/> | please complete section (B) |
| ii as a partnership (other than limited liability) | <input type="checkbox"/> | please complete section (B) |
| iii as an unincorporated association or | <input type="checkbox"/> | please complete section (B) |
| iv other (for example a statutory corporation) | <input type="checkbox"/> | please complete section (B) |
| c) a recognised club | <input type="checkbox"/> | please complete section (B) |
| d) a charity | <input type="checkbox"/> | please complete section (B) |
| e) the proprietor of an educational establishment | <input type="checkbox"/> | please complete section (B) |

- f) a health service body please complete section (B)
- g) a person who is registered under Part 2 of the Care Standards Act 2000 (c14) in respect of an independent hospital in Wales please complete section (B)
- ga) a person who is registered under Chapter 2 of Part 1 of the Health and Social Care Act 2008 (within the meaning of that Part) in an independent hospital in England please complete section (B)
- h) the chief officer of police of a police force in England and Wales please complete section (B)

* If you are applying as a person described in (a) or (b) please confirm (by ticking yes to one box below):

We are carrying on or proposing to carry on a business which involves the use of the premises for licensable activities; or

I am making the application pursuant to a statutory function or

a function discharged by virtue of Her Majesty's prerogative

(A) INDIVIDUAL APPLICANTS (fill in as applicable)

Mr <input type="checkbox"/>	Mrs <input type="checkbox"/>	Miss <input type="checkbox"/>	Ms <input type="checkbox"/>	Other Title (for example, Rev)	
Surname			First names		
Date of birth		I am 18 years old or over <input type="checkbox"/>		Please tick yes	
Nationality					
Current residential address if different from premises address					
Post town				Postcode	
Daytime contact telephone number					
E-mail address (optional)					
Where applicable (if demonstrating a right to work via the Home Office online right to work checking service), the 9-digit 'share code' provided to the applicant by that service (please see note 15 for information)					

SECOND INDIVIDUAL APPLICANT (if applicable)

Mr <input type="checkbox"/>	Mrs <input type="checkbox"/>	Miss <input type="checkbox"/>	Ms <input type="checkbox"/>	Other Title (for example, Rev)	
Surname			First names		
Date of birth	I am 18 years old or over		<input type="checkbox"/>	Please tick yes	
Nationality					
Where applicable (if demonstrating a right to work via the Home Office online right to work checking service), the 9-digit 'share code' provided to the applicant by that service: (please see note 15 for information)					
Current residential address if different from premises address					
Post town				Postcode	
Daytime contact telephone number					
E-mail address (optional)					

(B) OTHER APPLICANTS

Please provide name and registered address of applicant in full. Where appropriate please give any registered number. In the case of a partnership or other joint venture (other than a body corporate), please give the name and address of each party concerned.

Name	Tesco Stores Limited
Address	Tesco House, Shire Park, Kestrel Way, Welwyn Garden City, Hertfordshire, AL7 1GA
Registered number (where applicable)	00519500
Description of applicant (for example, partnership, company, unincorporated association etc.)	Private Limited Company
Telephone number (if any)	[REDACTED]
E-mail address (optional)	[REDACTED]

Part 3 Operating Schedule

When do you want the premises licence to start?

DD	MM	YYYY
<input type="text"/>	<input type="text"/>	<input type="text"/>

If you wish the licence to be valid only for a limited period, when do you want it to end?

DD	MM	YYYY
<input type="text"/>	<input type="text"/>	<input type="text"/>

Please give a general description of the premises (please read guidance note 1)

Retail premises (supermarket) selling a range of goods and services. This includes the sale of alcohol for consumption off the premises. Sales of alcohol for consumption off the premises are made from the supermarket sales floor as shown on the enclosed plan.

If 5,000 or more people are expected to attend the premises at any one time, please state the number expected to attend.

N/A

What licensable activities do you intend to carry on from the premises?

(Please see sections 1 and 14 and Schedules 1 and 2 to the Licensing Act 2003)

Provision of regulated entertainment (please read guidance note 2)

Please tick all that apply

- a) plays (if ticking yes, fill in box A)
- b) films (if ticking yes, fill in box B)
- c) indoor sporting events (if ticking yes, fill in box C)
- d) boxing or wrestling entertainment (if ticking yes, fill in box D)
- e) live music (if ticking yes, fill in box E)
- f) recorded music (if ticking yes, fill in box F)
- g) performances of dance (if ticking yes, fill in box G)
- h) anything of a similar description to that falling within (e), (f) or (g) (If ticking yes, fill in box H)

Provision of late-night refreshment (if ticking yes, fill in box I)

Supply of alcohol (if ticking yes, fill in box J)

In all cases complete boxes K, L and M

A

Plays Standard days and timings (please read guidance note 7)			<u>Will the performance of a play take place indoors or outdoors or both – please tick</u> (please read guidance note 3)	Indoors	<input type="checkbox"/>
Day	Start	Finish		Outdoors	<input type="checkbox"/>
				Both	<input type="checkbox"/>
Mon			<u>Please give further details here</u> (please read guidance note 4)		
Tue					
Wed			<u>State any seasonal variations for performing plays</u> (please read guidance note 5)		
Thur					
Fri			<u>Non-standard timings. Where you intend to use the premises for the performance of plays at different times to those listed in the column on the left, please list</u> (please read guidance note 6)		
Sat					
Sun					

B

Films Standard days and timings (please read guidance note 7)			<u>Will the exhibition of films take place indoors or outdoors or both – please tick</u> (please read guidance note 3)	Indoors	<input type="checkbox"/>
				Outdoors	<input type="checkbox"/>
				Both	<input type="checkbox"/>
Day	Start	Finish	<u>Please give further details here</u> (please read guidance note 4)		
Mon					
Tue					
			<u>State any seasonal variations for the exhibition of films</u> (please read guidance note 5)		
Wed					
Thur					
			<u>Non-standard timings. Where you intend to use the premises for the exhibition of films at different times to those listed in the column on the left, please list</u> (please read guidance note 6)		
Fri					
Sat					
Sun					

C

Indoor sporting events Standard days and timings (please read guidance note 7)			<u>Please give further details</u> (please read guidance note 4)
Day	Start	Finish	
Mon			
Tue			<u>State any seasonal variations for indoor sporting events</u> (please read guidance note 5)
Wed			
Thur			<u>Non-standard timings. Where you intend to use the premises for indoor sporting events at different times to those listed in the column on the left, please list</u> (please read guidance note 6)
Fri			
Sat			
Sun			

D

Boxing or wrestling entertainments Standard days and timings (please read guidance note 7)			Will the boxing or wrestling entertainment take place indoors or outdoors or both – please tick (please read guidance note 3)	Indoors	<input type="checkbox"/>
Day	Start	Finish		Outdoors	<input type="checkbox"/>
Mon			<u>Please give further details here</u> (please read guidance note 4)		
Tue					
Wed			<u>State any seasonal variations for boxing or wrestling entertainment</u> (please read guidance note 5)		
Thur					
Fri			<u>Non-standard timings. Where you intend to use the premises for boxing or wrestling entertainment at different times to those listed in the column on the left, please list</u> (please read guidance note 6)		
Sat					
Sun					

E

Live music Standard days and timings (please read guidance note 7)			<u>Will the performance of live music take place indoors or outdoors or both – please tick</u> (please read guidance note 3)	Indoors	<input type="checkbox"/>
				Outdoors	<input type="checkbox"/>
Day	Start	Finish		Both	<input type="checkbox"/>
Mon			<u>Please give further details here</u> (please read guidance note 4)		
Tue					
Wed			<u>State any seasonal variations for the performance of live music</u> (please read guidance note 5)		
Thur					
Fri			<u>Non-standard timings. Where you intend to use the premises for the performance of live music at different times to those listed in the column on the left, please list</u> (please read guidance note 6)		
Sat					
Sun					

F

Recorded music Standard days and timings (please read guidance note 7)			<u>Will the playing of recorded music take place indoors or outdoors or both – please tick</u> (please read guidance note 3)	Indoors	<input type="checkbox"/>
				Outdoors	<input type="checkbox"/>
				Both	<input type="checkbox"/>
Day	Start	Finish	<u>Please give further details here</u> (please read guidance note 4)		
Mon					
Tue					
Wed			<u>State any seasonal variations for the playing of recorded music</u> (please read guidance note 5)		
Thur					
Fri			<u>Non-standard timings. Where you intend to use the premises for the playing of recorded music at different times to those listed in the column on the left, please list</u> (please read guidance note 6)		
Sat					
Sun					

G

Performances of dance Standard days and timings (please read guidance note 7)			<u>Will the performance of dance take place indoors or outdoors or both – please tick</u> (please read guidance note 3)	Indoors	<input type="checkbox"/>
Day	Start	Finish		Outdoors	<input type="checkbox"/>
Mon			<u>Please give further details here</u> (please read guidance note 4)	Both	<input type="checkbox"/>
Tue					
Wed			<u>State any seasonal variations for the performance of dance</u> (please read guidance note 5)		
Thur					
Fri			<u>Non-standard timings. Where you intend to use the premises for the performance of dance at different times to those listed in the column on the left, please list</u> (please read guidance note 6)		
Sat					
Sun					

H

Anything of a similar description to that falling within (e), (f) or (g) Standard days and timings (please read guidance note 7)			Please give a description of the type of entertainment you will be providing		
Day	Start	Finish	<u>Will this entertainment take place indoors or outdoors or both – please tick</u> (please read guidance note 3)	Indoors	<input type="checkbox"/>
Mon				Outdoors	<input type="checkbox"/>
				Both	<input type="checkbox"/>
Tue			<u>Please give further details here</u> (please read guidance note 4)		
Wed					
Thur			<u>State any seasonal variations for entertainment of a similar description to that falling within (e), (f) or (g)</u> (please read guidance note 5)		
Fri					
Sat			<u>Non-standard timings. Where you intend to use the premises for the entertainment of a similar description to that falling within (e), (f) or (g) at different times to those listed in the column on the left, please list</u> (please read guidance note 6)		
Sun					

I

Late-night refreshment Standard days and timings (please read guidance note 7)			Will the provision of late-night refreshment take place indoors or outdoors or both – please tick (please read guidance note 3)	Indoors	<input type="checkbox"/>
Day	Start	Finish		Outdoors	<input type="checkbox"/>
Mon			<u>Please give further details here</u> (please read guidance note 4)	Both	<input type="checkbox"/>
Tue					
Wed			<u>State any seasonal variations for the provision of late-night refreshment</u> (please read guidance note 5)		
Thur					
Fri			<u>Non-standard timings. Where you intend to use the premises for the provision of late-night refreshment at different times, to those listed in the column on the left, please list</u> (please read guidance note 6)		
Sat					
Sun					

J

Supply of alcohol Standard days and timings (please read guidance note 7)			<u>Will the supply of alcohol be for consumption – please tick</u> (please read guidance note 8)	On the premises	<input type="checkbox"/>
				Off the premises	<input checked="" type="checkbox"/>
				Both	<input type="checkbox"/>
Day	Start	Finish	<u>State any seasonal variations for the supply of alcohol</u> (please read guidance note 5)		
Mon	11:00	20:00			
Tue	11:00	20:00			
Wed	11:00	20:00			
Thur	11:00	20:00			
Fri	11:00	20:00			
Sat	11:00	20:00			
Sun	11:00	20:00			
			<u>Non-standard timings. Where you intend to use the premises for the supply of alcohol at different times to those listed in the column on the left, please list</u> (please read guidance note 6)		

State the name and details of the individual whom you wish to specify on the licence as designated premises supervisor (Please see declaration about the entitlement to work in the checklist at the end of the form):

Name Mr. Steven Nicholas Andrzejuk	
Date of birth	[REDACTED]
Address	
[REDACTED]	
[REDACTED]	
Postcode	[REDACTED]
Personal licence number (if known)	
[REDACTED]	
Issuing licensing authority (if known)	
[REDACTED]	

K

Please highlight any adult entertainment or services, activities, other entertainment or matters ancillary to the use of the premises that may give rise to concern in respect of children (please read guidance note 9).

N/a

L

Hours premises are open to the public Standard days and timings (please read guidance note 7)			State any seasonal variations (please read guidance note 5)
Day	Start	Finish	
Mon	06:00	23:00	<p>Non-standard timings. Where you intend the premises to be open to the public at different times from those listed in the column on the left, please list (please read guidance note 6)</p>
Tue	06:00	23:00	
Wed	06:00	23:00	
Thur	06:00	23:00	
Fri	06:00	23:00	
Sat	06:00	23:00	
Sun	06:00	23:00	

M

Describe the steps you intend to take to promote the four licensing objectives:

a) General – all four licensing objectives (b, c, d, and e) (please read guidance note 10)

Tesco is a large national operator with a range of head office and local support. The company has devised policies, procedures, systems, and training to ensure that they sell alcohol in a responsible manner.

There is a detailed programme which ensures that comprehensive training is provided to employees having regard to their role and the responsibilities and such training is regularly reviewed, and records kept.

b) The prevention of crime and disorder

We will have a digital CCTV system that covers the premises, including the main area which will be used for display of alcohol. Images will be retained for 31 days.

A member of the management team will be on the premises all the time the store is open. This colleague will have responsibility for the premises and will be the initial point of contact for any issues that may arise.

Please see pre agreed conditions with Cambridgeshire Constabulary in Appendix 1.

c) Public safety

The premises licence holder is fully aware of its responsibilities under a range of health and safety related legislation and has policies and procedures in place to be confident of complying with the relevant obligations which arise.

Please see pre agreed conditions with Cambridgeshire Constabulary in Appendix 1.

d) The prevention of public nuisance

The company has a “good neighbour” ethos which seeks to ensure that the premises plays an active part in the local community.

Please see pre agreed conditions with Cambridgeshire Constabulary in Appendix 1.

e) The protection of children from harm

The premises will operate a Think 25 policy. The checkouts will be programmed to prompt the customer assistant when an alcohol product is scanned at the checkout to follow the Think 25 policy.

All colleagues will receive training in relation to the underlying law and Tesco policy, systems, and procedures. This training will be documented, and refresher training will be provided on a regular basis.

Please see pre agreed conditions with Cambridgeshire Constabulary in Appendix 1.

Appendix 1

1. A member of the Management team will ordinarily be on the premises all the time the store is open and this person will have responsibility for the premises whilst the premises are open.
2. The premises licence holder shall maintain adequate levels of staff at the premises. Such staff levels shall be disclosed, on reasonable request to the licensing authority and the police.
3. Digital CCTV with appropriate recording equipment shall be installed. The CCTV to cover areas of the store including the alcohol section, checkouts and the entrance and exit to the premises.
 - a. The CCTV system shall record footage when the premises is open for licensable activities.
 - b. CCTV equipment must be maintained in good working order, be correctly time and date stamped and must be retained for a minimum period of 31 consecutive days.
 - c. The CCTV at exit points will record a clear facial image of every person entering or exiting in any light condition.
 - d. An appointed member of staff will be present when the premises is conducting a licensable activity, who is capable and competent at using the CCTV system and downloading CCTV footage on their own recordable media, and be able to hand this footage over to the Police / Local Authority on request. The operator will stock their own downloaded media. The recording equipment and discs/USB pen drives must be kept in a secure environment.
4. Body worn video (BWV) device shall be available and worn by the SIA security officer whenever licensable activities are taking place.
 - a. The BWV device must be maintained in good working order, be correctly time and date stamped and must be retained for a minimum period of 31 consecutive days.
5. A risk assessment will be completed on a regular basis to review the requirements of a SIA guard.
6. A member of staff shall be present in the checkout area whenever licensable activities are taking place.
7. Beer, lager or cider products with an AVB content of 5.5% or above shall not be sold at the premises except for premium or craft products or such other products specifically agreed for sale by the police.
8. Cider products shall not be stocked in containers greater than 1 litre in volume.
9. The store shall join the Cambridge Business Against Crime and operate a CAMBAC radio (or any similar scheme which succeeds CAMBAC).
10. There shall be no self-service of spirits or sherry at the premises.
11. A representative of the premises licence holder shall attend meetings of the City West Neighbourhood Policing Panel (or any similar panel which may succeed this panel) when requested to do so by the police.
12. The premises shall operate an incident log (whether electronic or physical) and shall record all significant incidents of crime and disorder or refusals of the sale of alcohol within it. Such log shall be made available for inspection by the police upon reasonable request.

13. The premises will operate a Think 25 policy. The checkouts will be programmed to prompt the checkout assistant when an alcohol product is scanned at the till to follow the Think 25 policy.
14. All staff will receive comprehensive training in relation to age restricted products and in particular the sale of alcohol. No member of staff will be permitted to sell age restricted products until such time as they have successfully completed the aforementioned training. In addition, they will receive training in relation to Tesco's policies, systems and procedures. This training will be documented and repeated as often as Tesco believes to be appropriate.
15. A maximum of 15 percent of the trading floor area to which the public have access shall be used for the display of alcohol at any one time.
16. Alcohol available for self-selection is displayed within lockable cabinets to ensure that during non-licenced hours the public are not able to access the alcohol products. (During these hours cabinets are permitted to be temporarily unlocked to allow staff access).

Checklist:

Please tick to indicate agreement

- I have made or enclosed payment of the fee.
- I have enclosed the plan of the premises.
- I have sent copies of this application and the plan to responsible authorities and others where applicable.
- I have enclosed the consent form completed by the individual I wish to be designated premises supervisor, if applicable.
- I understand that I must now advertise my application.
- I understand that if I do not comply with the above requirements my application will be rejected.
- [Applicable to all individual applicants, including those in a partnership which is not a limited liability partnership, but not companies or limited liability partnerships] I have included documents demonstrating my entitlement to work in the United Kingdom or my share code issued by the Home Office online right to work checking service (please read note 15).

IT IS AN OFFENCE, UNDER SECTION 158 OF THE LICENSING ACT 2003, TO MAKE A FALSE STATEMENT IN OR IN CONNECTION WITH THIS APPLICATION. THOSE WHO MAKE A FALSE STATEMENT MAY BE LIABLE ON SUMMARY CONVICTION TO A FINE OF ANY AMOUNT.

IT IS AN OFFENCE UNDER SECTION 24B OF THE IMMIGRATION ACT 1971 FOR A PERSON TO WORK WHEN THEY KNOW, OR HAVE REASONABLE CAUSE TO BELIEVE, THAT THEY ARE DISQUALIFIED FROM DOING SO BY REASON OF THEIR IMMIGRATION STATUS. THOSE WHO EMPLOY AN ADULT WITHOUT LEAVE OR WHO IS SUBJECT TO CONDITIONS AS TO EMPLOYMENT WILL BE LIABLE TO A CIVIL PENALTY UNDER SECTION 15 OF THE IMMIGRATION, ASYLUM AND NATIONALITY ACT 2006 AND PURSUANT TO SECTION 21 OF THE SAME ACT, WILL BE COMMITTING AN OFFENCE WHERE THEY DO SO IN THE KNOWLEDGE, OR WITH REASONABLE CAUSE TO BELIEVE, THAT THE EMPLOYEE IS DISQUALIFIED.

Part 4 – Signatures (please read guidance note 11)

Signature of applicant or applicant’s solicitor or other duly authorised agent (see guidance note 12). If signing on behalf of the applicant, please state in what capacity.

Declaration	<ul style="list-style-type: none"> • [Applicable to individual applicants only, including those in a partnership which is not a limited liability partnership] I understand I am not entitled to be issued with a licence if I do not have the entitlement to live and work in the UK (or if I am subject to a condition preventing me from doing work relating to the carrying on of a licensable activity) and that my licence will become invalid if I cease to be entitled to live and work in the UK (please read guidance note 15). • The DPS named in this application form is entitled to work in the UK (and is not subject to conditions preventing him or her from doing work relating to a licensable activity) and I have seen a copy of his or her proof of entitlement to work, or have conducted an online right to work check using the Home Office online right to work checking service which confirmed their right to work (please see note 15)
Signature	
Date	12/04/2024
Capacity	Ms. Hardish Purewal – Licensing Manager Duly authorised agent, for and on behalf of Tesco Stores Limited

For joint applications, signature of 2nd applicant or 2nd applicant's solicitor or other authorised agent (please read guidance note 13). If signing on behalf of the applicant, please state in what capacity.

Signature	
Date	
Capacity	

Contact name (where not previously given) and postal address for correspondence associated with this application (please read guidance note 14)

Tesco Licensing Team,
Shire Park, Kestrel Way,

Post town	Welwyn Garden City	Postcode	AL7 1GA
-----------	---------------------------	----------	----------------

Telephone number (if any) [REDACTED]

If you would prefer us to correspond with you by e-mail, your e-mail address (optional)

[REDACTED]

EAST ROAD

TOTAL DEPTH OF STORE 18.46 M

TOTAL WIDTH OF STORE 23.51 M

TESCO

ENTRANCE/EXIT

Shared Service Yard



REV	DATE	AMENDMENTS

ADDRESS: 172 E Rd
Cambridge, Cambridgeshire
CB1 1BG United Kingdom

FIRE DETECTION LEGEND

	SOUNDER
	VISUAL INDICATOR (BEACON)
	6KG 27A FOAM & 2KG CO2 EXTINGUISHERS
	AREA COVERED BY SMOKE DETECTIONS
	BREAK GLASS CALL POINT

RED LINE MEANING: The red line denotes the area of the premises to be licensed space

PROJECT:
CAMBRIDGE EAST RD

DESCRIPTION
PROPOSED SITE
BWS LICENSE LAYOUT

DRAWING NO. CAMBRIDGEFeasp# #BWSPLAN

PHASE 2 ISSUE ##

SYSTEM ID. No. CAMBRIDGEFeasp# #.dwg

SCALE	DATE
NTS@A3	19.01.2024

PLANNING	DEAN
MANAGER	PREECE

TBS PLANNER	MOHAMMED
	AFLAH K H

TESCO
FEASIBILITY PLANNING
STORE PLANNING DEPARTMENT
PROPERTY SERVICES
HIGHWOODS BUILDING, KESTREL WAY
WELWYN GARDEN CITY, HERTFORDSHIRE, AL7 1GB UK
TELEPHONE : 01707 395150

THE COPYRIGHT AND ALL OTHER RIGHTS IN AND RELATING TO THIS PUBLICATION BELONG TO AND ARE THE SOLE PROPERTY OF TESCO STORES LIMITED. ALL RIGHTS ARE RESERVED. NEITHER THE WHOLE NOR ANY PART OF THIS PUBLICATION MAY BE REPRODUCED OR TRANSMITTED IN ANY FORM OR BY ANY ELECTRONIC OR MECHANICAL MEANS INCLUDING PHOTOCOPYING AND RECORDING OR FROM ANY RETRIEVAL SYSTEM WITHOUT THE PRIOR WRITTEN LICENCE FROM THE OWNER © 2019 TESCO STORES LIMITED.

EAST ROAD

Page 34

TOTAL DEPTH OF STORE 18.46 M

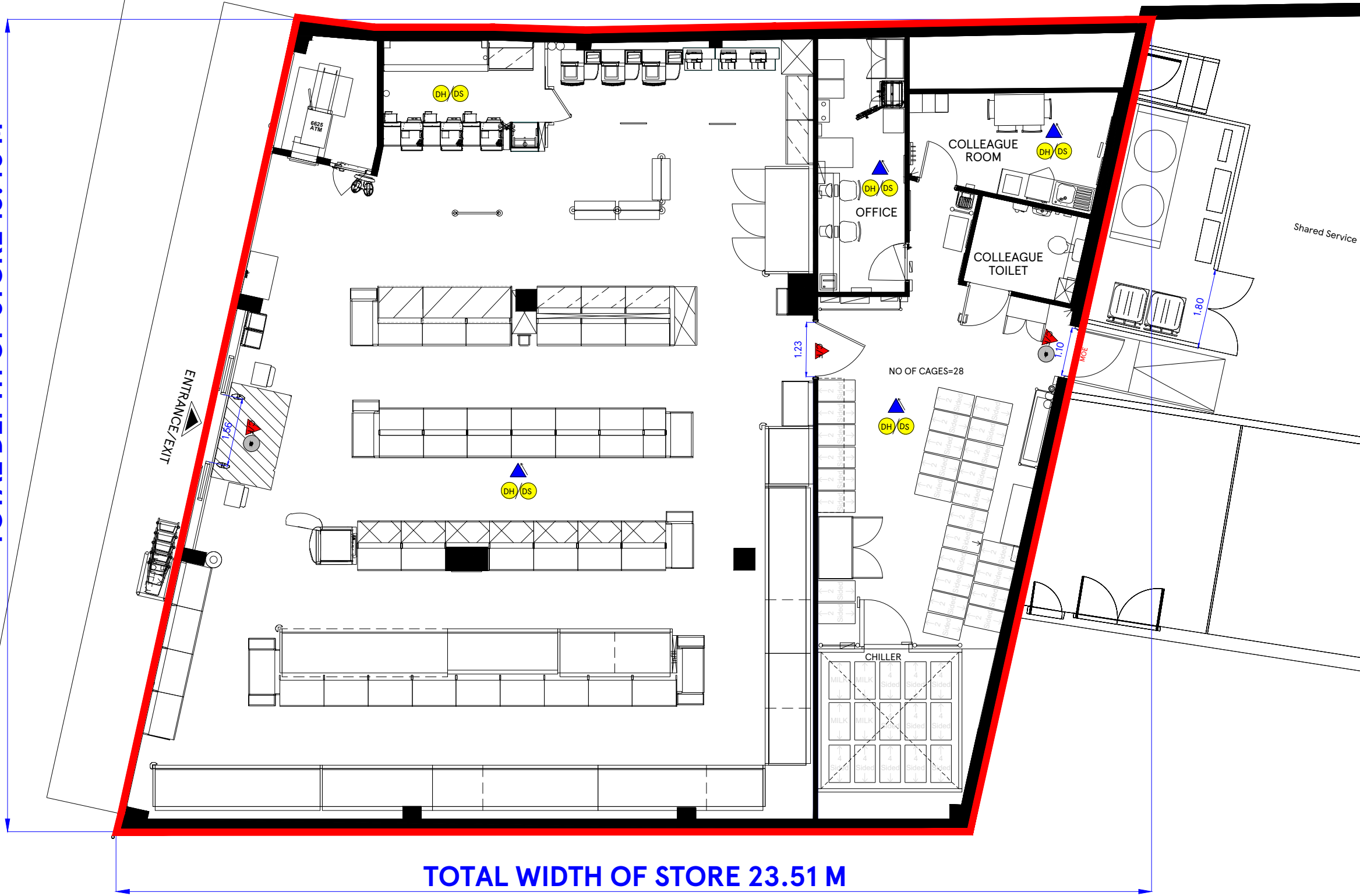

TOTAL WIDTH OF STORE 23.51 M

REV	DATE	AMENDMENTS

ADDRESS: 172 E Rd
Cambridge, Cambridgeshire
CB1 1BG United Kingdom

- FIRE DETECTION LEGEND**
- SOUNDER
 - VISUAL INDICATOR (BEACON)
 - 6KG 27A FOAM & 2KG CO2 EXTINGUISHERS
 - AREA COVERED BY SMOKE DETECTIONS
 - BREAK GLASS CALL POINT

RED LINE MEANING: The red line denotes the area of the premises to be licensed space

PROJECT:
CAMBRIDGE EAST RD

DESCRIPTION:
PROPOSED RETAIL BWS LICENSE LAYOUT

DRAWING NO. CAMBRIDGEFeasgag#BWSPLAN

PHASE **2** ISSUE **##**

SYSTEM ID. No. CAMBRIDGEFeasrg##.dwg
CAMBRIDGEFeasbg##.dwg

SCALE **1:100@A3** DATE **19.01.2024**

PLANNING MANAGER **DEAN PREECE**

TBS PLANNER **MOHAMMED AFLAH K H**

TESCO

FEASIBILITY PLANNING
STORE PLANNING DEPARTMENT
PROPERTY SERVICES
HIGHWOODS BUILDING, KESTREL WAY
WELWYN GARDEN CITY, HERTFORDSHIRE, AL7 1GB UK
TELEPHONE : 01707 395150

THE COPYRIGHT AND ALL OTHER RIGHTS IN AND RELATING TO THIS PUBLICATION BELONG TO AND ARE THE SOLE PROPERTY OF TESCO STORES LIMITED. ALL RIGHTS ARE RESERVED. NEITHER THE WHOLE NOR ANY PART OF THIS PUBLICATION MAY BE REPRODUCED OR TRANSMITTED IN ANY FORM OR BY ANY ELECTRONIC OR MECHANICAL MEANS INCLUDING PHOTOCOPYING AND RECORDING OR FROM ANY RETRIEVAL SYSTEM WITHOUT THE PRIOR WRITTEN LICENCE FROM THE OWNER © TESCO STORES LIMITED.

From: Lesley Abrams [REDACTED]
Sent: Monday, April 29, 2024 9:27 AM
To: licensing (CCity) licensing@cambridge.gov.uk
Subject: 172 East Road

I am concerned about the off-licence application by the Tesco on East Road. There are already plenty of outlets for alcohol in the area, and it really doesn't need another. At times the atmosphere on my street (Guest Road) has been very unpleasant, as drinkers pass through, or stay drinking for a while, sitting on my front wall, on their way from the main roads to the cemetery or elsewhere. This is intimidating as well as unpleasant. Night-time drinking on my street also means unsightly and potentially harmful littering, as empty bottles and half-eaten take-away food are left behind for us to clear up. Easier access to alcohol on East Road would increase this general public nuisance and also probably make the Burleigh Street end of the Grafton Centre area in particular less pleasant. I would stop going to the Grafton Centre shops if so.

I hope the council will not grant this licence.

Yours sincerely,

Lesley Abrams
23 Guest Road

Firstname: Julie Surname: Murphy

Address: 4 The Old School, Norfolk Street, Cambridge, Cambridgeshire CB1 2LE

Telephone: [REDACTED]

Email: [REDACTED]

I would like to enter my opposition to the premises licence application by Tesco, Unit 1, 172 East Road, Cambridge, Cambridgeshire, CB1 1BG. I live on Norfolk Street and work at St. Matthews Primary school. I have lived on Norfolk Street for 20 years. In the past I have been a Governor at St. Matthew's Primary School. The school is located directly across the road from the Tesco Express, with windows looking directly onto said area of East Road. Living and working just 300 meters from the Tesco Express I feel that I know the area very well. This shop is also located just down the road from Jimmy's Night Shelter. Located on East Road, the Tesco Express is within the Cumulative Impact Area Market Ward. According to the current 2023 Statement of Licensing Policy on the Cambridge City website there are currently 254 licensed premises in Market ward (the highest number in the city). The statement also shows there have been 665 alcohol related crimes and incidents (also highest number in the city). In this report it was recommended that Market Ward should remain a Cumulative Impact Area. This part of the city has a problem with aggressive beggars, rough sleepers, street drinkers, drug dealers, as well as drug users. This part of Market Ward (The Kite) has very few, if any, police on foot patrol. People are sleeping rough in the doorways of many of the surrounding businesses, as well as in the front of the Tesco Express itself. Not to mention the fights and shouting matches that currently take place in front of the very said Tesco Express. In their application Tesco state that they will have digital CCTV that will cover many areas of the shop floor, that a member of the Management team will ordinarily be on the premises, as well as a security guard. They currently have a security guard on the door but still have a problem with shoplifters; management ordinarily being on the premises doesn't sound very convincing to me either as there are rarely staff on hand to help at the tills. As far as their "Good Neighbour" policy, I have never seen them engage in the community at all, they only contribute to the amount of beggars and litter on East Road. To my knowledge they don't get involved with the local primary or secondary school, nor with PACT (Petersfield Area Community Trust). There also seems to be a certain amount of bravado amongst the current staff who have been telling customers that the license is a sure thing. I hope that this application will be turned down, as they have been in the past.

Thank you, Julie Murphy

I Object to the granting of a licence to sell alcohol at Tesco on 172 East Road, Cambridge, Cambridgeshire CB1 1BG.

This premises is directly across the street from the 600-pupil St Matthew's Primary School and is also very near the vulnerable adults who are accommodated at Jimmy's Night Shelter.

East Road has for many years been trying to tackle serious problems with public drunkenness and associated antisocial behaviour. It has been a Cumulative Impact Zone.

The City Council website (<https://democracy.cambridge.gov.uk/mgAi.aspx?ID=21556>) records Item 19/9/Lic of the Meeting of Premises licence application, Licensing Sub Committee, dated Monday, 4th February, 2019. This meeting **rejected** that previous licence application for this same Tesco Express, at 172 East Road. Then, as now, this Tesco was located directly across the street from the 600-pupil St Matthew's Primary School and was then also very near to Jimmy's Night Shelter.

The reasons given for this refusal were:

"The application was likely to add to the existing cumulative impact. Relevant representations had been made, the applicant had made very little attempt to demonstrate why the operation of the premises involved would not add to the cumulative impact already being experienced."

The 2024 level of public drunkenness, as well as both drug and alcohol abuse continues to be a serious problem that must **not** be exacerbated by the approval of a licence at Tesco's on East Road.

Please note that these comments draw on my knowledge and experience as:

- a parent of children formerly at both St Matthew's Primary School and at Parkside Community College;
- formerly, a Vice Chair of the Governing Body at St Matthew's Primary School;
- formerly, Chair of the Petersfield Community Trust (PACT); and
- an active and concerned local resident of the St Matthew's area of Petersfield, of well over 40 years standing.

This is a supplement to my previous Objection (submitted 25 April 2024 at 22:28:02 BST).

After reading through Tesco's "Offered Conditions" (with difficulty due to the lack of formatting on your website), I note that there is no suggested restriction on sale of alcohol to individuals who are clearly already drunk or high. A serious omission.

Yours sincerely,

Dr J V Neal

6 Edward Street

Cambridge CB1 2LS



From: Dan Kunkle [REDACTED]

Sent: Sunday, April 28, 2024 2:49 PM

To: licensing (CCity) <licensing@cambridge.gov.uk>

Subject: 172 East Rd

Dear City Council,

As a 20-year resident of Petersfield, I strongly urge you to deny Tesco's request for an alcohol license on East Road. Because of Jimmy's establishment, there is a well established gathering of street drinkers and drug users in the immediate area, creating an atmosphere of threatening behavior, crime, noise, litter and excrement.

There are already excessive alcohol outlets in the area.

Yours sincerely

Dan Kunkle

1 Petersfield

CB1 1BB

[REDACTED]

From: [REDACTED]

Sent: Sunday, April 28, 2024 11:12 PM

To: licensing (CCity) licensing@cambridge.gov.uk

Subject: Against East Road Tesco's application for an alcohol 'off licence'

To whom it may concern,

I am writing to request that East Road Tesco's application for an alcohol 'off licence' be rejected. As a resident, I witness too much alcohol-related anti-social behaviour, crime and disorder. If Tesco is allowed to sell alcohol, the situation will only worsen. And of course, there are already too many alcohol outlets in such a small part of Cambridge.

Kind regards,

[REDACTED]

[REDACTED]

From: [REDACTED]

Sent: Sunday, April 28, 2024 11:53 AM

To: licensing (CCity) licensing@cambridge.gov.uk

Subject: 172 East road

Good morning,

I am emailing providing my objection on giving a license for alcohol to Tesco on East road. It's bad enough that I witness drug dealing on an almost daily basis around the outside of Tesco and on burleigh street on a daily basis. With Jimmy's homeless shelter only a few metres away, having alcohol available at Tesco would exacerbate public nuisance and likely impact public safety negatively.

I was born and raised on [REDACTED]. I remember when alcohol was available on East road and the negative impact it had on the area. Let's not go backwards on this issue.

My details:

[REDACTED]

Best wishes,

[REDACTED]

From: Aidan H <[REDACTED]>
Sent: Monday, April 29, 2024 12:02 PM
To: licensing (CCity) <licensing@cambridge.gov.uk>
Subject: 172 East Rd

Hello,

I would like to object to the granting of an alcohol off licence at the Tesco store on East Road.

I am concerned that the sale of alcohol in this store would adversely affect public safety and the protection of children in the nearby Primary school by

- encouraging those who drink on the street to congregate in the area
- encouraging those who beg for change, which I notice happens almost continually outside other outlets that sell alcohol (e.g. the Sainsbury's near the railway station and on Hills Rd)
- increasing the occurrence of shop-lifting (which I have witnessed already happens in this branch of Tesco's) to increase.

Yours faithfully,

Aidan Hawkes
4, Blossom St, Cambridge, CB1 2NQ

From: jenny kirner <[REDACTED]>
Sent: Monday, April 29, 2024 10:21 PM
To: licensing (CCity) <licensing@cambridge.gov.uk>
Subject: Tesco East Road

Dear Licensing,

I am writing to let you know that I am concerned about Tesco on East Road selling alcohol. I live locally on Petersfield Green close to Jimmies and the rowdy drinking groups can get quite intimidating especially in the summer. Groups gather outside Jimmies on the green at the entrance to the green from East Road.

This is intimidating for people wanting to enter the green space and can make the green an unpleasant place to be. This situation interferes with the enjoyment of the children's play area. Parents do not feel comfortable bringing children to the play area when there are rowdy drinkers present.

If alcohol was sold at Tesco, I would expect the amount of drinkers hanging around on East Road between Petersfield Green and Tesco to increase. ARU and St Matthews school are also on East Road and attracting more drinkers here this would not be good for the pupils, students as well as the residents.

To summarise, my concerns are that an increase in drinkers would increase the public nuisance already experienced in the Petersfield, Bradmore Street, East Road area. It would increase crime and disorder as well as public safety through alcohol fuelled intimidating behaviour and an increase in drinkers on the green space would mean children are affected by the reduced use of the play area.

Yours sincerely

Jennifer Kirner
10 Petersfield

From: Caroline Wilson <[REDACTED]>
Sent: Thursday, May 2, 2024 11:06 AM
To: licensing (CCity) <licensing@cambridge.gov.uk>
Subject: 172 East Road

I wish to register my objection to the application for an alcohol licence by the Tesco Stores in East Road

The nearby area is already plagued by anti-social behaviour and the granting of a licence for these premises would only exacerbate the problems. The area includes Mill Road cemetery; an area in which I have a particular interest as I am a member of the committee of the Friends of Mill Road Cemetery; the cemetery is plagued by alcohol and substance abuse and making alcohol still easier to obtain would be deleterious.

Caroline Wilson
2 Willis Road
CB1 2AQ

From: Cllr Martin Smart (Cambridge City - Kings Hedges) [REDACTED]

Sent: Friday, May 3, 2024 9:55 PM

To: licensing (CCity) <licensing@cambridge.gov.uk>

Subject: Tesco at 172 East Road

Hi

Tesco at 172 East Road

I am writing both as a local resident and as a City Councillor.

I object to the application to grant an alcohol licence to Tesco, address as above.

I live locally, and have done for over 30 years. My children attended St Matthew's and I was Chair of governors there for eight years. I objected as Chair of governors when they applied previously. I believe it will have a detrimental effect on the children at that school, and protection of children from harm is a very important matter, including their mental health. I am also concerned about crime and disorder that might result, plus public safety and public nuisance.

This application is in a City Council Cumulative Impact Zone and I believe this application would add unreasonably to that, and that there are plenty enough sources of alcohol in the area already.

Please reject this application.

Regards

Martin

Councillor Martin Smart (he/him pronouns)
Deputy Leader of the Council - Non Statutory
King's Hedges ward | Cambridge City Council
[REDACTED]

From: Cllr Anthony Martinelli (Cambridge City - Market) [REDACTED]
Sent: Tuesday, May 7, 2024 1:46 PM
To: licensing (CCity) <licensing@cambridge.gov.uk>;
Subject: PRECAM 000948 Tesco 172 East Road (Objection)

As city councillors representing Market Ward, within which this premises lies, we formally object to this application for selling alcohol at Tesco, 172 East Road. This premises sits within the City Centre Cumulative Impact Zone and we believe that a further shop selling alcohol within the CIZ will exacerbate problems experienced with antisocial behaviour, public disorder and nuisance in the Fitzroy Street/Burleigh Street area. Alcohol-related antisocial behaviour has been a problem within this area for many years and we do not anticipate this will improve, particularly as the nearby Parkside police station is planned to be closed within the coming years. There are several establishments selling alcohol within a short distance of this site, including WT's, Duke of Cambridge, Six Six, and The Blue Moon: adding an additional venue for off sales therefore increases the risk of public disorder due to alcohol overuse. Problems with alcohol usage in this area are also related to issues with rough sleeping and begging, which continue to be a major concern within the city centre and in this part of the city centre in particular. Should this licence be approved, we are concerned that we would see an increase in alcohol-related antisocial behaviour, crime, and injury (and reduced public safety) secondary to increased consumption. We also note its proximity to schools and therefore are concerned that increased street drinking in this area may create a risk to children. We urge the committee to reject this application.

Many thanks,

Cllr Anthony Martinelli
Cllr Tim Bick
Cllr Katie Porrer

Licence number	PRECAM 000948
Premises name	Tesco
Premises address	UNIT 1, 172 East Road, CAMBRIDGE, Cambridgeshire, CB1 1BG
Proposed licence holder	Tesco Stores Limited
Consultation start date	12-04-2024
Consultation end date	10-05-2024

Timothy Rufus Neal
6 Edward Street
Cambridge CB1 2LS



OBJECTION TO GRANTING OF LICENSE

Submitted 8 May 2024

My objection

A similar application has been made before and refused. What has changed?

This is the very worst place to put an off license – it will add to already extant and well-documented problems – crime and disorder, public safety, public nuisance and potential harm to children.

Burleigh Street is just round the corner with a large number of homeless sleeping in doorways and swigging beer or drink from early to late and often verbally and physically aggressive.

Burleigh Street is a main thoroughfare to town on Friday and Saturday nights, so putting an off license there is clearly going to add to problems that already exist. Jimmy's Night Shelter is just down the road, so more potential for nuisance and disorder.

If that is not enough St Matthews school is just across the road. The obvious dangers of attracting people who not only drink until they are dangerous and those who leave needles in the shrubbery everywhere near this school where the Council has a duty to keep the children safe from harm should be enough to refuse the application on its own. If Tesco wanted to have a shop with a liquor license, they should have put the shop somewhere else.

The application clearly adds to the cumulative impact right in the middle of an area that already has enough problems, and should be refused.

From: Ivan Hare KC <[REDACTED]>
Sent: Tuesday, April 30, 2024 11:10 AM
To: licensing (CCity) <licensing@cambridge.gov.uk>
Subject: 172 East Road

Hello,

I am a local resident and object strongly to the application by Tesco, East Road for an alcohol off-licence. The frequent incidents of alcohol-related anti-social behaviour on the East Road and Petersfield Terrace have led me to advice my three children to avoid the area altogether.

Best wishes,

Ivan Hare
6 Willis Road
CB1 2AQ

[REDACTED]

[REDACTED]

[REDACTED]



[REDACTED]

From: [REDACTED]
Sent: Monday, April 29, 2024 7:18 PM
To: licensing (CCity) <licensing@cambridge.gov.uk>
Subject: Tesco Alcohol licence application.

I strongly object to the granting of any license to Tesco's or any one else seeking a license in the vicinity.. The area is overrun with drunks and there are several places to buy alcohol within a short walking distance.
NO NO NO!

[REDACTED]

Thank you

As a councillor for Petersfield ward I object strongly to this application.

I am very concerned about this application for an alcohol licence at the Tesco store on East Road. The store does not have such a licence and this is the third time they have tried to get one having twice before been refused.

There are already sufficient alcohol outlets in the area and adding to them just increases the likelihood of excessive drinking. The city council's policy is to recognise the cumulative impact of all the existing licenses and seek to prevent new ones being allowed.

The Cumulative Impact Zone policy for the areas around East Rd has just recently been reviewed and renewed for another three years. The report which led to the policy renewal includes ample evidence of the problems encountered as a result excess availability and consumption of alcohol on the streets and parks of this area.

I have marked the location of the Tesco's store on East Rd on these two maps which were included in the impact policy review report. The maps show the location of crimes and incidents recorded by the police in the year to 31st March 2023. Later last year there were numerous reports of problems with street drinkers in the area, particularly on Petersfield Green.

Alcohol related crimes



Alcohol related incidents



During the last year and especially in summer months residents of Petersfield terrace, Bradwell St, and Petersfield mansions make numerous complaints to me about the noise

and drunkenness in front of the homes. Allowing further premises to sell alcohol would be to risk exacerbating the current position.

I do not believe that the proposals put forward by the applicant for controlling the sales of alcohol from the premises, such as only selling limited strength alcohol and limiting the hours within which alcohol could be sold, would be enough to prevent the problems, and risk the area being worsened by the licence being granted.

Residents have also voiced concerns about the risk of harm to children in the area - physical, moral and psychological. St Matthews Primary School is opposite the applicant's premises and there are three children's play areas close by - on Petersfield green, in flower St, and on the East Rd estate.

For these reasons I feel that all four of the criteria for assessing licence applications are at risk if this application is allowed ie prevention of crime and disorder, public safety, prevention of public nuisance, protection of children from harm.

Yours sincerely

Richard
Cllr Richard Robertson
Petersfield Ward
Cambridge City Council

6 Gurney Way, Cambridge CB4 2ED

[REDACTED]

[REDACTED]
[REDACTED]
[REDACTED]
[REDACTED]

[REDACTED]
[REDACTED]

I am writing to object the proposed license to sell alcohol at the East Road Tesco. Our primary concern is the continual and worsening anti-social behaviour during the day and throughout the night all week within the area. There are already enough pubs, late night clubs and other supermarkets where alcohol is readily available alongside the easily accessible delivery companies that operate 24/7. Why do we need another outlet which would increase and exacerbate the problem? There has been no outreach or proactive consultation inviting the community to consider and discuss this application, given the negative impact it will have on residents, families and our children at St. Matthew's primary school. We can only assume there has not been any direct communication with the school as we've received no correspondence from St Matthew's telling us that they have been notified of the application. The application only seems to address the security and training of staff within the premises and clearly does not take into account the cumulative effect on the area. It obviously and cynically prioritises profit and greed over people and communities who have to live and work here. How would the managers/shareholders like to live in this environment 24/7? We are trying to make the area a safer and more pleasant place to live free of intimidation, broken glass, vomit and aggressive levels of behaviour and noise.

[REDACTED]

[REDACTED]

[REDACTED]

[REDACTED]

I am writing to object the proposed license to sell alcohol at the East Road Tesco. Our primary concern is the continual and worsening anti-social behaviour during the day and throughout the night all week within the area. There are already enough pubs, late night clubs and other supermarkets where alcohol is readily available alongside the easily accessible delivery companies that operate 24/7. Why do we need another outlet which would increase and exacerbate the problem? There has been no outreach or proactive consultation inviting the community to consider and discuss this application, given the negative impact it will have on residents, families and our children at St. Matthew's primary school. We can only assume there has not been any direct communication with the school as we've received no correspondence from St Matthew's telling us that they have been notified of the application. The application only seems to address the security and training of staff within the premises and clearly does not take into account the cumulative effect on the area. It obviously and cynically prioritises profit and greed over people and communities who have to live and work here. How would the managers/shareholders like to live in this environment 24/7? We are trying to make the area a safer and more pleasant place to live free of intimidation, broken glass, vomit and aggressive levels of behaviour and noise.

The application is for an alcohol 'off licence' at the Tesco store on East Road. The store does not have such a licence and this is the third time they have tried to get one having twice before been refused.

I am of the view there are already sufficient alcohol outlets in the area and more just increases the likelihood of excessive drinking. The city council's policy is to recognise the cumulative impact of all the existing licenses and seek to prevent new ones being allowed. The Cumulative Impact Zone policy for the area around the East Rd has just recently been reviewed and renewed for another three years.

The area around East Rd has a long history of alcohol related anti social behaviour, particularly in the vicinity of Petersfield Terrace, Bradmore St and Petersfield Mansions. It would add to the problem if Tesco were allowed to sell alcohol at their East Rd store. I am objecting on the following grounds

- Public safety
- Prevention of public nuisance
- Protection of children from harm
- Prevention of crime and disorder

I am the ward Cllr for Petersfield. I live at 18 Riverside, Cambridge, CB5 8HL

Thank you ,

Mike Davey

This page is intentionally left blank

Luke Catchpole

From: Licensing South [REDACTED]
Sent: 02 May 2024 11:17
To: licensing (CCity)
Cc: [REDACTED]
Subject: Tesco East Road application

Categories: Licensing application

Dear licensing authority,

Please find email thread below detailing Tesco's agreement to replace condition 5 in Appendix 1 to state the following:

- A security officer shall be on duty at the premises whenever licensable activities are taking place.

Kind regards,

Clare

[REDACTED]
Operational Planning and Licensing | Partnerships and Operational Support
[REDACTED]

Cambridgeshire Constabulary

Hinchingsbrooke Park,
Huntingdon, PE29 6NP

Follow us on [Twitter](#), [Facebook](#), [Instagram](#) and [YouTube](#)

Working together to deliver an inclusive and professional policing service

With: Fairness, Integrity, Diligence and Impartiality.



From: Purewal, Hardish [REDACTED]
Sent: Thursday, May 2, 2024 11:12 AM
To: [REDACTED]

Subject: Fwd: East Rd, Cambridge

Hi Clare

Please see below. I agreed to change this condition.

Thanks
Hardish

Sent from [Outlook for iOS](#)

From: Purewal, Hardish
Sent: Wednesday, April 17, 2024 9:11:52 AM
[REDACTED]
Subject: FW: East Rd, Cambridge

Please can you send this to the LA.

As a result of further discussions with the and if the premises licence is granted for Tesco Stores Ltd, East Rd, Cambridge, we will be happy to amend the current security guard condition from

- A risk assessment will be completed on a regular basis to review the requirements of a SIA guard.

To

- A security officer shall be on duty at the premises whenever licensable activities are taking place.

Thanks

From: Purewal, Hardish
Sent: Wednesday, April 17, 2024 9:10 AM
[REDACTED]
Subject: East Rd, Cambridge

Hi Claire

If the premises licence is granted for Tesco Stores Ltd, East Rd, Cambridge, we will be happy to amend the current security guard condition from

- A risk assessment will be completed on a regular basis to review the requirements of a SIA guard.

To

- A security officer shall be on duty at the premises whenever licensable activities are taking place.

Thanks
Hardish

This is a confidential email. Tesco may monitor and record all emails. The views expressed in this email are those of the sender and not Tesco. Tesco Stores Limited Company Number: 519500 Registered in England Registered Office: Tesco House, Shire Park, Kestrel Way, Welwyn Garden City, AL7 1GA VAT Registration Number: GB 220 4302 31

Internet e-mail is not to be treated as a secure means of communication. Cambridgeshire Constabulary monitors all internet e-mail activity and content. This communication is confidential and intended for the addressee(s) only. Please notify the sender if you have received this in error. Unauthorised use or disclosure of the contents may be unlawful. Opinions expressed in this document may not be official policy.

For more details please see [Cambridgeshire Constabulary Privacy Policy](#)

Appendix 1

1. A member of the Management team will ordinarily be on the premises all the time the store is open and this person will have responsibility for the premises whilst the premises are open.
2. The premises licence holder shall maintain adequate levels of staff at the premises. Such staff levels shall be disclosed, on reasonable request to the licensing authority and the police.
3. Digital CCTV with appropriate recording equipment shall be installed. The CCTV to cover areas of the store including the alcohol section, checkouts and the entrance and exit to the premises.
 - a. The CCTV system shall record footage when the premises is open for licensable activities.
 - b. CCTV equipment must be maintained in good working order, be correctly time and date stamped and must be retained for a minimum period of 31 consecutive days.
 - c. The CCTV at exit points will record a clear facial image of every person entering or exiting in any light condition.
 - d. An appointed member of staff will be present when the premises is conducting a licensable activity, who is capable and competent at using the CCTV system and downloading CCTV footage on their own recordable media, and be able to hand this footage over to the Police / Local Authority on request. The operator will stock their own downloaded media. The recording equipment and discs/USB pen drives must be kept in a secure environment.
4. Body worn video (BWV) device shall be available and worn by the SIA security officer whenever licensable activities are taking place.
 - a. The BWV device must be maintained in good working order, be correctly time and date stamped and must be retained for a minimum period of 31 consecutive days.
5. A security officer shall be on duty at the premises whenever licensable activities are taking place
6. A member of staff shall be present in the checkout area whenever licensable activities are taking place.
7. Beer, lager or cider products with an AVB content of 5.5% or above shall not be sold at the premises except for premium or craft products or such other products specifically agreed for sale by the police.
8. Cider products shall not be stocked in containers greater than 1 litre in volume.
9. The store shall join the Cambridge Business Against Crime and operate a CAMBAC radio (or any similar scheme which succeeds CAMBAC).
10. There shall be no self-service of spirits or sherry at the premises.
11. A representative of the premises licence holder shall attend meetings of the City West Neighbourhood Policing Panel (or any similar panel which may succeed this panel) when requested to do so by the police.
12. The premises shall operate an incident log (whether electronic or physical) and shall record all significant incidents of crime and disorder or refusals of the sale of alcohol within it. Such log shall be made available for inspection by the police upon reasonable request.
13. The premises will operate a Think 25 policy. The checkouts will be programmed to prompt the checkout assistant when an alcohol product is scanned at the till to follow the Think 25 policy.
14. All staff will receive comprehensive training in relation to age restricted products and in particular the sale of alcohol. No member of staff will be permitted to sell age restricted products until such time as they have successfully completed the aforementioned training. In addition, they will receive training in relation to Tesco's policies, systems and procedures. This training will be documented and repeated as often as Tesco believes to be appropriate.
15. A maximum of 15 percent of the trading floor area to which the public have access shall be used for the display of alcohol at any one time.
16. Alcohol available for self-selection is displayed within lockable cabinets to ensure that during non-licenced hours the public are not able to access the alcohol products. (During these hours cabinets are permitted to be temporarily unlocked to allow staff access).

This page is intentionally left blank